

Taymor | PRODUCT SPECIFICATIONS

ASTRAL

FEATURES

- ▶ INCLUDES MOUNTING PLATES* 1-3/16" x 1-3/16" (30 mm x 30 mm) - STEEL
- *PAPER/TOWEL HOLDER 1-15/32" x 1-13/32" (37 mm x 36 mm) - ZINC
- NYLON ANCHORS AND STEEL PHILLIPS HEAD SCREWS: #8 x 1-1/4" (32 mm)
- ▶ SOLID ZINC DIE-CAST CONSTRUCTION (POSTS)

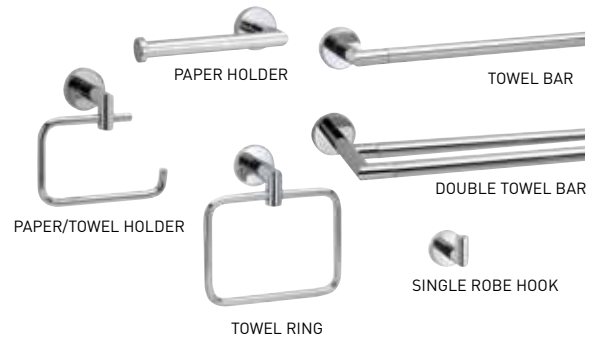

TOWEL BAR

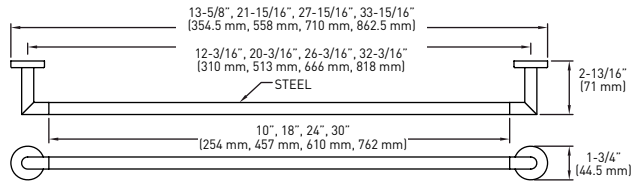

DOUBLE TOWEL BAR

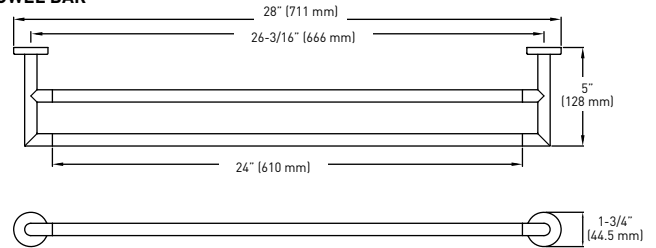

SINGLE ROBE HOOK

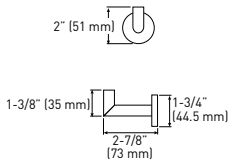

TOWEL RING

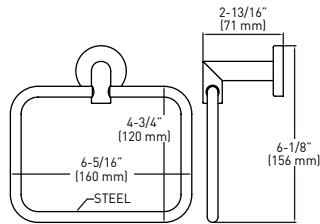

PAPER HOLDER/TOWEL HOLDER

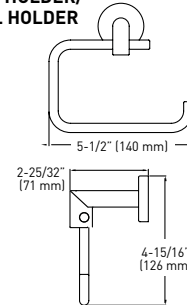

PAPER HOLDER

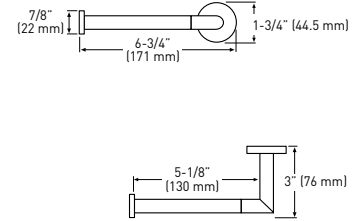

MEASUREMENTS SUBJECT TO A 3% VARIANCE.

RETAIL PACK	SATIN NICKEL 15	MATTE BLACK 19	POLISHED CHROME 26	MATERIAL	CASE PACK
18" TOWEL BAR	-	-	02-D2818	ZINC/STEEL	4
24" TOWEL BAR	-	-	02-D2824	ZINC/STEEL	4
30" TOWEL BAR	-	-	02-D2830	ZINC/STEEL	4
24" DOUBLE TOWEL BAR	-	-	02-D2824D	ZINC/STEEL	4
SINGLE ROBE HOOK	-	-	02-D2801	ZINC	4
TOWEL RING	-	-	02-D2804A	ZINC/STEEL	4
PAPER HOLDER	-	-	02-D2848	ZINC/STEEL	4
PAPER/TOWEL HOLDER	-	-	02-D2838	ZINC/STEEL	4
BUILDER PACK					
10" TOWEL BAR	04-SN2810	04-2810BLK	04-2810	ZINC/STEEL	10
18" TOWEL BAR	04-SN2818	04-2818BLK	04-2818	ZINC/STEEL	10
24" TOWEL BAR	04-SN2824	04-2824BLK	04-2824	ZINC/STEEL	10
SINGLE ROBE HOOK	04-SN2801	04-2801BLK	04-2801	ZINC	10
PAPER HOLDER	04-SN2848	04-2848BLK	04-2848	ZINC/STEEL	10
PAPER/TOWEL HOLDER	-	04-2838BLK	-	ZINC/STEEL	10
TOWEL RING	04-SN2804A	-	04-2804A	ZINC/STEEL	10

